

# ANALOGUE DOOR ENTRY/TELEPHONE INTERFACE

The DVT1 enables door entry calls to be picked up by a standard internal telephone or diverted to an external number.

- Standard telephone can be used for Door Entry calls as well as for external calls
- Door Entry calls can be diverted to external number (eg. mobile)
- Interval times programmable
- Easy installation
- Power supply 12v AC/13.8v DC

The DVT1 Analogue Door Entry/Telephone Interface enables a standard telephone handset to be used both for door entry applications and external telephone calls. The DVT1 automatically switches the internal handset between door entry calls and external calls. If the internal telephone is already in use, a warning tone will be heard until the existing call is terminated or the other call stops. As soon as the existing call is terminated the handset will be switched automatically to the incoming call. An external telephone number, such as that of a mobile phone can be programmed into the system so that if a door entry call to the internal phone is not answered within a pre-determined time, the call will be diverted automatically to the external number. The electric door lock release can be operated by pressing \*\* or #.

Although the time intervals between each stage of the DVT1 operating cycle are factory preset, these times can be varied within specific limits.



**RAYTEL SECURITY SYSTEMS** 

helping to make communities safer

# DOOR ENTRY/TELEPHONE INTERFACE

## Function Diagram

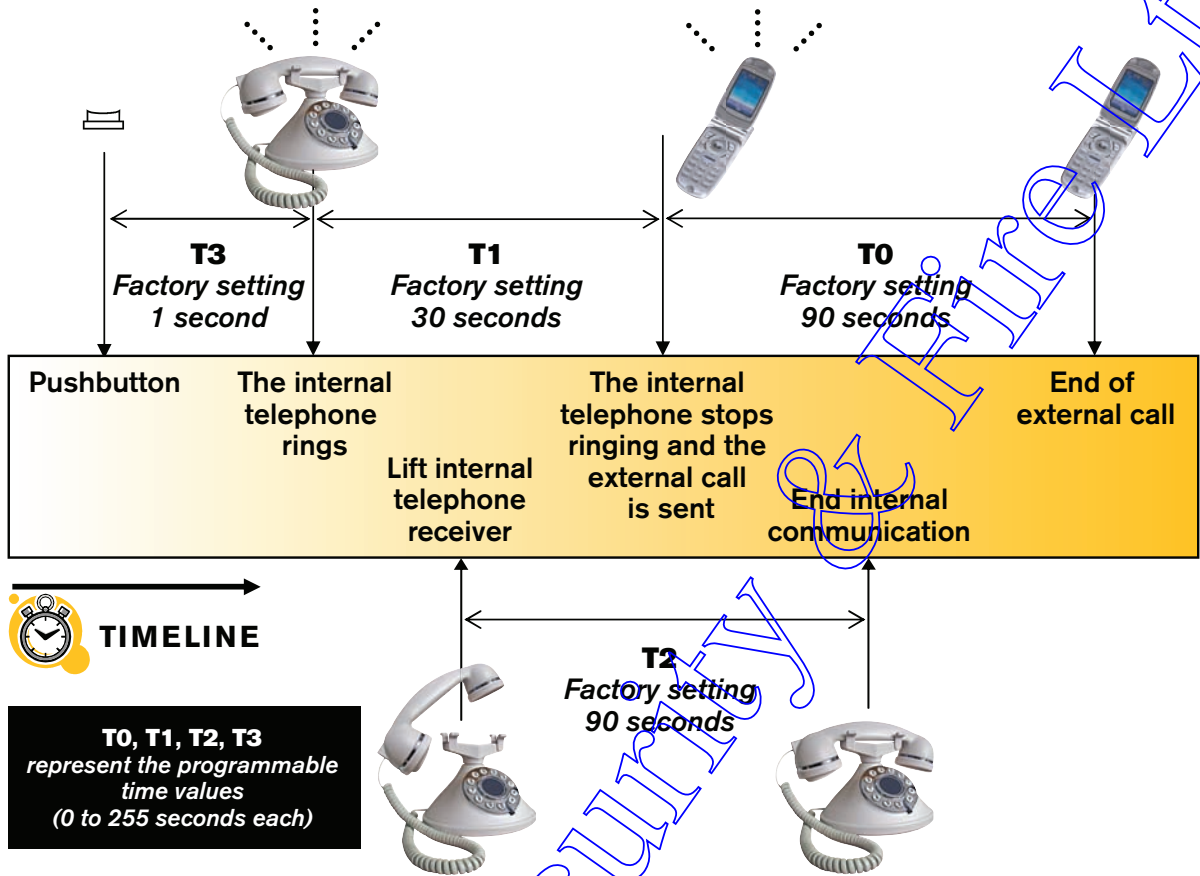

## Dimensions (mm)

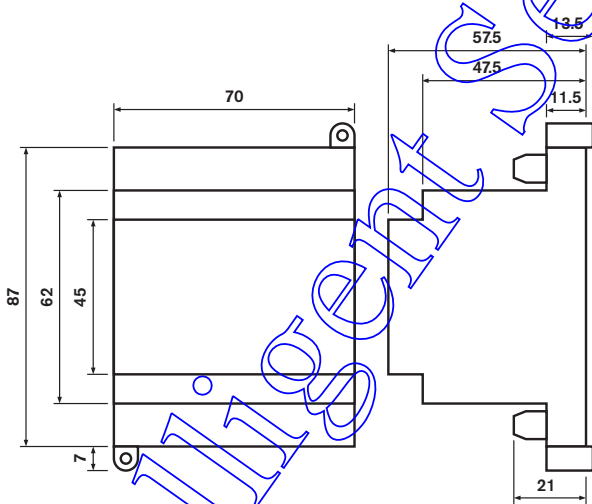

## Dimensions (mm)

