

Passive Repeater Panel DF6000PR



simple user interface



DF6000PR passive repeater panel



2 x 40 backlit LCD display and 6 supervisory LED's

Overview

The DF6000PR is a cost effective passive repeater panel which can be programmed via its informative display to be either fully passive (display only) or semi passive (restricted system control).

When loop connected the repeater panel will display the system information text of the connected control panel and will provide a fire indication, with panel number, of any connected network control panel that has fire activation.

The DF6000PR repeater panel only requires programming with local text information.

In addition to the repeater panels main menu driven 2 x 40 backlit LCD display, which provides system status information, it also has 6 supervisory LED's (Power On, Alarm, Trouble, Supervisory, Test In Progress, and Scroll).

Features

- Up to 20 repeaters can be connected to the loop
- 2 x 40 backlit LCD display and 6 supervisory LED's
- Compact size
- Can be surface or semi-recessed mounted

Benefits

- Menu driven easy to operate
- Simple connection to panel loop circuit reduces wiring and installation time
- Distance run up to 2km from main panel without additional cable and equipment, saving cost

Dimensions

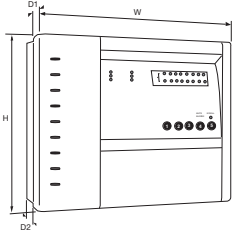

| H (mm) | W (mm) | D1 (mm) | D2 (mm) |
|--------|--------|---------|---------|
| 270 | 332 | 45 | 47 |

Technical Specification

| | |
|---------------------------|---|
| Code | CF30000PR |
| Description | Passive repeater panel |
| Standards | EN54 Pt4 |
| Specification | |
| Mains Input Voltage | 230V ac +10% / -15% |
| Operating Voltage | 24V dc |
| System Indicators | Power on, fire, fault, test, disable and scroll |
| System Controls | Silence alarms, evacuate and reset |
| Input Ports | RS232 (for connection of programmer) |
| Battery | 1 x 12V 3.2Ah |
| Standby Duration | 24 hours |
| Environmental | |
| Operating Temperature | 0°C to +25°C |
| Humidity (Non Condensing) | 0 to 75% RH |
| Physical | |
| Construction | PC/ABS |
| Colour | Light Grey |
| Dimensions (H x W x D) | 332mm x 270mm x 92mm |
| Weight | 3.6kg |
| Ingress Protection | IP30 |
| Compatibility | |
| Suitable for use with | Menvier intelligent addressable fire systems |

Loop Connected

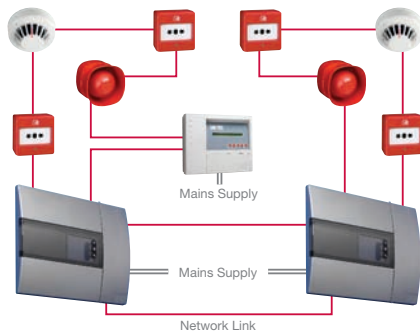

Note: In this configuration the repeater would give 'text' information for the panel that is on the loop, but only address number for the other panel on the network.

Network Connected

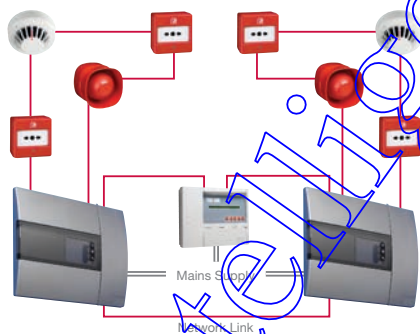

Installation

1. Wall mounted by means of 4 fixing screws.
2. Cable entry at top or back.
3. 12 top entry gland holes with push out blanking plugs.
4. 4 separate rear access cable entry facilities.
5. Local mains supply required.

System Functionality

1. Panel operates in either normal, supervisor or engineer mode.
2. Supervisor and engineer modes are accessed via 4 digit pass codes.
3. Supervisor mode allows silence, evacuate and reset commands to be sent to host panel (loop connected) or to network (network connected).
4. Engineer mode enables password to be changed if required and allows access to text download menu
5. When connected to network, all text is transmitted via network, changes to other network panels update automatically.

Standard Connection

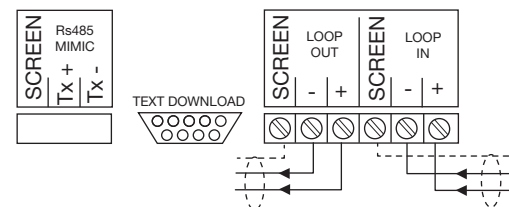

Product Codes

| Code | Description |
|------------|---|
| DF6000PR | Intelligent addressable passive repeater panel, loop connected |
| DF6000PRNC | Intelligent addressable passive repeater panel, network connected |

6. When connected to a detector loop, text for host is downloaded to repeater and updated manually as required.
7. Zonal fire and fault indication is by means of 2 x 40 character LCD display.

Device Overview

1. Panel can be connected to either the detection loop of a single panel or to a network as part of a networked system.
2. Supplied with integral power supply and standby battery.